



### BAG STYLES:



### MAXIMUM SPEED:

Up to **220** cycles per minute

### MAXIMUM BAG SIZE:

250 mm x 1000 mm  
(9.84" x 39.3")

### MINIMUM BAG SIZE:

50 mm x 110 mm  
(2" x 4.33")

### VIKING MASEK VFFS

E250

E400

ES400

M250

M250 BiB

M400

M500

M650

S250

S400

SACHET SA300-SA500

**SIGMA**

STICK PACK ST200-ST800

VELOCITY

**CONTINUOUS MOTION BAG-MAKER FOR A VARIETY OF BAG STYLES INCLUDING QUAD SEAL AND FLAT BOTTOM!**



## FEATURES:

- Linear magnetic drives
- Robust stainless steel frame
- Intermittent or continuous motion
- Enclosed, servo drive jaw actuation
- Vacuum pull belts
- Automatic film tracking
- VFD powered film unwind
- Off-the-shelf components
- Minimal maintenance requirements
- Product stagers
- End-seal cooling air
- Bag deflators
- Photo eye and encoder
- Quick film splice table
- Jaw obstruction detection
- Siemens controls
- Storage for 100 product recipes

## OPTIONS:

- Quad seal bag assembly
- Flat bottom bag assembly
- Doy-style bag assembly
- Gusset bag assembly
- Integration with variety of fillers, printers, metal detectors, label applicators, and checkweighers
- Hole punch (Euroslot and Round)
- Load shelf
- Product settler
- Gas flush
- Static eliminator
- Tear notch
- In-feed and take-away conveyors
- Remote diagnostics

## SIGMA VIEWS:

FRONT

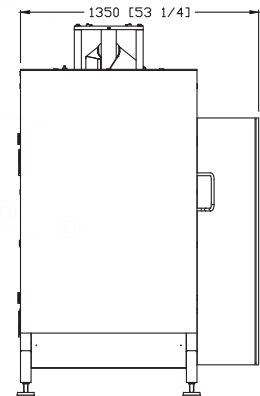

SIDE

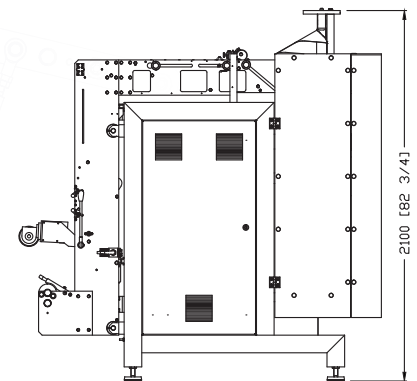

TOP

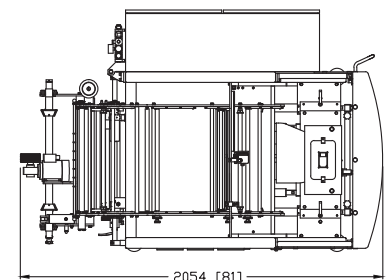

Standard views, dimensions may vary.

